

**Monofase - Singola cella**

Questo filtro è indicato per qualsiasi dispositivo elettronico che richieda un filtro di linea.  
Si caratterizza per una bassissima corrente di fuga.  
L'attenuazione media di questo filtro è pari a circa 50-60 dB.

**Single phase - Single stage**

This filter is indicated for whichever electronic device that demands a line filter.  
It is characterized for a very low leakage current.  
The medium insertion loss of this filter is around 50-60 dB.



Corrente di fuga Leakage current	< 0.5 mA
Categoria climatica Climatic category	25/085/21 (IEC 60068-1)



MODELLI Model List	Codice Code	Corrente nom. [A] Rated current	Tensione nom. [V] Rated voltage	L [mH]	C <sub>x</sub> [μF]	C <sub>y</sub> [nF]	R [MΩ]	Dimensioni Case size L x W x D	Peso Weight
MSC01/250	23900MSC01	1	115/250	2x4	0.1	2x4.7	-	46 x 32 x 22 mm	65 g
MSC03/250	23900MSC03	3		2x1.8	0.1	2x3.3	-	44 x 24 x 19 mm	150 g
MSCB06/250	2390MSCB06	6		2x4	2x0.47	2x1.0	0.68	63 x 51 x 38 mm	250 g
MSC10/250	23900MSC10	10		2x1.2	2x0.1	2x3.3	1	51 x 51 x 29 mm	190 g
MSC20/250	23900MSC20	20		2x1.5	2x0.33	2x3.3	1	51 x 51 x 29 mm	140 g
MSC30/250	23900MSC30	30		2x0.3	2x0.1	2x3.3	1.5	64 x 50 x 36 mm	250 g

**DIMENSIONI [mm] - Dimensions [mm]**

MSC01	MSC03	MSCB06
MSC10	MSC20	MSC30

**Monofase - Doppia cella**

Questo filtro monofase a doppia cella fornisce interessanti livelli di attenuazione che arrivano anche a ca. 80 dB. Su richiesta vengono realizzate serie speciali.

**Single phase - Double stage**

This double stage filter has interesting attenuation levels (up to approximately 80 dB). Special versions available on request.



Corrente di fuga Leakage current	< 0.5 mA
Categoria climatica Climatic category	25/085/21 (IEC 60068-1)



MODELLI Model List	Codice Code	Corrente nom. [A] Rated current	Tensione nom. [V] Rated voltage	L [mH]	C <sub>x</sub> [µF]	C <sub>y</sub> [nF]	R [MΩ]	Dimensioni Case size L x W x D	Peso Weight
MDC03/250	23900MDC03	3	115/250	2x4+2x8	2x0.47	2x3.3	1.5	63 x 52 x 29 mm	15 g
MDC06/250	23900MDC06	6		2x1+2x1	3x0.1	2x3.3	2.2	63 x 52 x 29 mm	185 g
MDC10/250	23900MDC10	10		2x0.6+2x0.6	3x0.1	2x4.7	2.2	63 x 52 x 29 mm	190 g
MDC20/250	23900MDC20	20		2x1+2x1	3x0.22	2x4.7	2.2	73 x 56 x 44 mm	300 g
MDC30/250	23900MDC30	30		2x1.2+2x1.2	3x0.47	2x4.7	0.68	99 x 84 x 38 mm	630 g

**DIMENSIONI [mm] - Dimensions [mm]**

**MDC03**

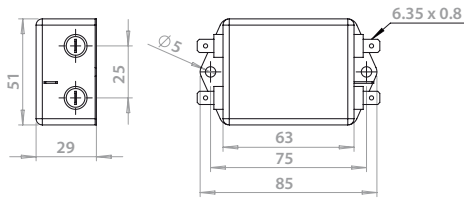

**MDC06**

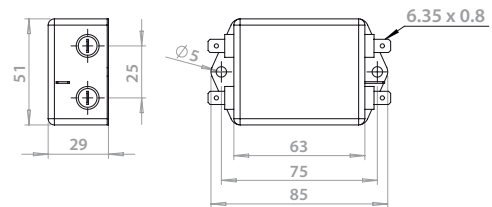

**MDC10**

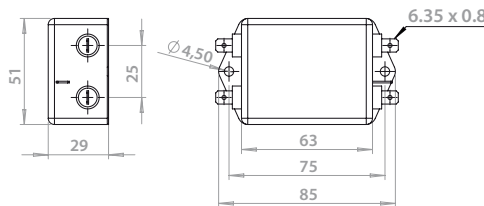

**MDC20**

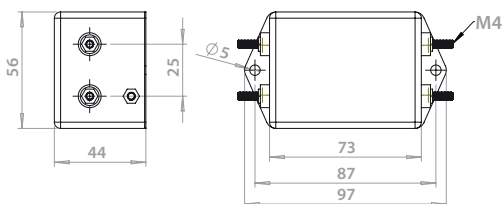

**MDC30**

